



Main

Range of product	Telemecanique Cabling components
Accessory / separate part categor	Cabling accessories
Accessory / separate part type	Connector
Electrical connection	Elbowed female connector DIN 43650 A, 4 pins
Status LED	Without
Cable connection	Screw terminal / wire size <math>< 1.5 \text{ mm}^2</math> / clamping capacity 7...10 mm

Complementary

Cable gland type	Pg 11
Cable connector fixing	Locking screw
[Ue] rated operational voltage	250 V AC
[In] rated current	16 A
Enclosure material	Plastic
Minimum insulating resistance	0.1 GΩ
Contact resistance	4000 μOhm
Net weight	0.035 kg

Environment

IP degree of protection	IP65
Ambient air temperature for operation	-40...125 °C

Packing Units

Unit Type of Package 1	PCE
Number of Units in Package 1	1
Package 1 Height	3.000 cm
Package 1 Width	10.000 cm
Package 1 Length	10.000 cm
Package 1 Weight	33.000 g
Unit Type of Package 2	S02
Number of Units in Package 2	50
Package 2 Height	15 cm
Package 2 Width	30 cm
Package 2 Length	40 cm
Package 2 Weight	1.962 kg

Offer Sustainability

California proposition 65	WARNING: This product can expose you to chemicals including: Diisononyl phthalate (DINP), which is known to the State of California to cause cancer, and Di-isodecyl phthalate (DIDP), which is known to the State of California to cause birth defects or other reproductive harm. For more information go to www.P65Warnings.ca.gov
For all Reach Rohs enquiries contact us at	sustainability@tesensors.com

Contractual warranty

Warranty

18 months

Dimensions

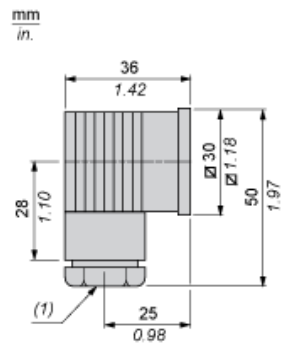

(1) Pg 11 cable gland

Connections and Schemes

